

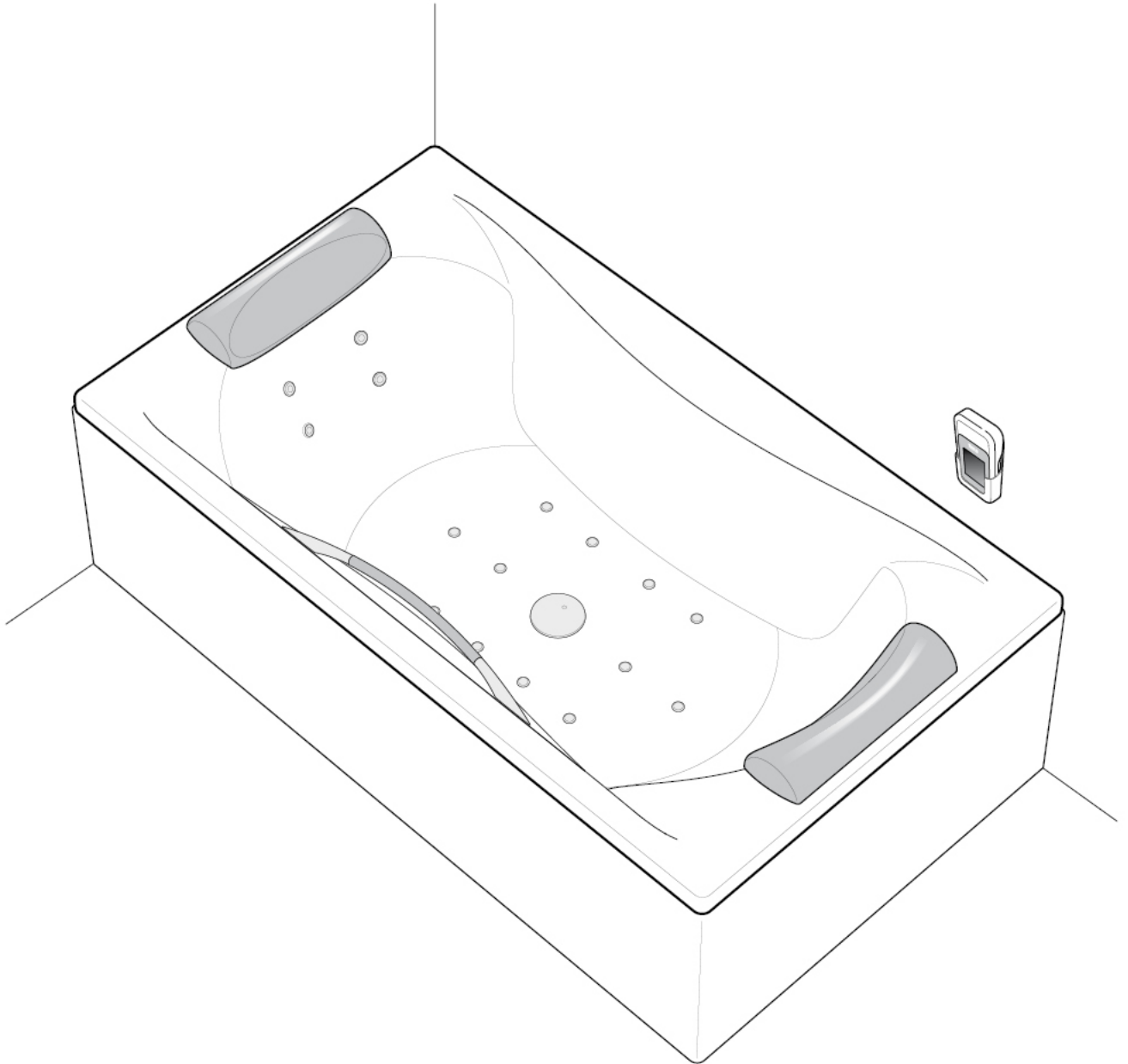

Roca

TOTAL PREMIUM



We congratulate you and thank you for purchasing this Roca product, which has been designed, manufactured and checked by our technical staff.

Likewise, if you purchased the panel, it will include specific instructions for installing it.

EFFECTS OF MASSAGE

The action of the air bubbles on the body has been proven to be highly beneficial for the health. The following effects are particularly worth mentioning:

- Stimulates and improves skin hygiene and cardiovascular circulation.
- Generally improves capillary and lymph circulation.
- Tones the muscles and oxygenates the skin.
- Particularly indicated in cases of muscle pain, lumbago, arthritis, post-operative convalescence, stress and fatigue in general.

PRECAUTIONS

- This device is not intended to be used by people (including children) whose physical, sensory or mental capabilities are reduced, or no experience or knowledge, unless they have supervision or instructions concerning the use of the apparatus by a person responsible for security.
- Cleaning and maintenance of this device must not be done by children without supervision.
- Children should be supervised to ensure they do not play with the device.
- In spite of the preventive and relaxing therapeutic effects of hydro-massage, it is important to note that in the case of acute conditions, uncompensated heart disease, serious hypertension or certain infectious diseases, and in the case of certain groups (children, the elderly, and pregnant women), certain special conditions regarding bath duration, temperature and frequency must be borne in mind. In these situations it is advisable to consult your doctor first.
- It is recommended not to take a bath directly after drinking alcohol or having a meal.
- Use only water from your home network properly treated and disinfected.
- If the water hardness of the installation is very high, it is advisable to install a water softener to guarantee that the whirlpool equipment is working properly.
- Do not use foam-bath products with the whirlpool since the amount of foam produced could lead to overflows.

INSTALLATION AND MAINTENANCE

- To guarantee the safety of use of this product, it should only be installed and repaired by qualified installers, who can demonstrate to the appropriate authorities awareness and competence in the application of National Regulatory requirements for safety, i.e. electrical and water supply/disposal.

| | | | |
|------------------------------------|---|---|----|
| Contents | 3 | Chromotherapy | 8 |
| Description | 4 | ■ Selection of predefined colors and cycles | 8 |
| ■ Whirlpool bathtub | 4 | Other functions | 9 |
| ■ Remote control | 4 | ■ Temperature maintenance | 9 |
| Main screens | 4 | ■ Timer | 9 |
| Adjustment screen | 4 | ■ Programs | 10 |
| Basic functions | 5 | Save new programs | 10 |
| ■ Direct activation of functions | 5 | ■ Ozone disinfection | 11 |
| ■ Power selection screen / options | 5 | ■ Tools | 12 |
| ■ Lack of water | 5 | Final blowing | 12 |
| ■ Water temperature alarm | 5 | Demo Mode | 12 |
| Hydromassage functions | 6 | Restore | 13 |
| ■ Water massage | 6 | Synchronization | 13 |
| ■ Soft massage (water+air) | 6 | Status | 13 |
| ■ Air massage | 7 | Troubleshooting | 14 |
| ■ Pulsating air massage | 7 | Maintenance | 15 |

Description

Whirlpool bathtub

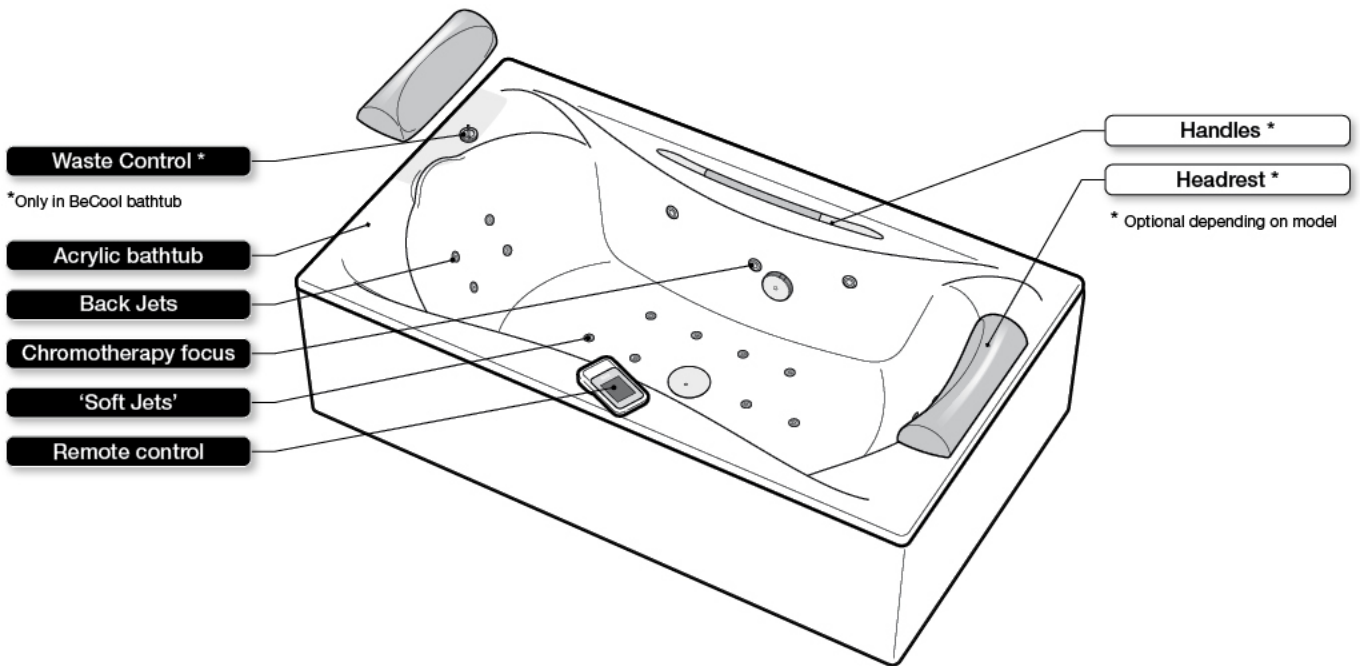

Remote control

The unit has a remote control with color touch screen that can be used inside and outside the bathtub to control the hydromassage functions.

The screen changes to power saving mode after 10 seconds without pulsation. To activate it again, you should press 1 time in any part of the screen.



⚠ It is required to place the batteries to use the remote control (see pg. 15)

It is necessary to synchronize the remote control with the bathtub before first use. (see pg. 13)

Main screens

| Main menu | |
|-----------|----------------------------|
| 1 | 26°C 15' |
| 2 | 1 Water temperature |
| 3 | 2 Remaining time |
| 4 | 3 Water massage |
| 5 | 4 Soft massage (water+air) |
| 6 | 5 Air massage |
| 7 | 6 Pulsating air massage |
| 8 | 7 Chromotherapy |
| | 8 Next menu |

| Other functions | |
|-----------------|--|
| 1 | 26°C H P 15' |
| 2 | 1 Temperature maintenance ON indicator |
| 3 | 2 Programa ON indicator |
| 4 | 3 Temperature maintenance |
| 5 | 4 Timer |
| 6 | 5 Programs |
| 7 | 6 Ozone disinfection |
| 8 | 7 Tools |
| | 8 Previous menu |

= level adjustment
 = submenu

Adjustment screen

| | | |
|---|---|---------------------|
| 1 | | 1 Function selected |
| 2 | 1 | 2 Level indicator |
| 3 | | 3 Decrease |
| 4 | | 4 Increase |
| 5 | | 5 Previous Menu |

Direct activation of functions

Function is enabled in the default level.

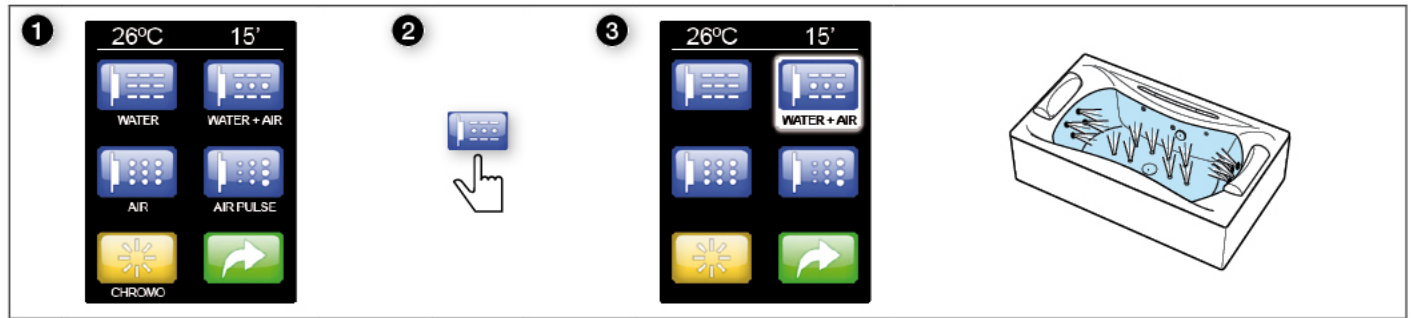

Power selection screen / options

Level selection to increase or decrease the intensity / options value. If the value set is "0", the function stops.



Lack of water

When the water level in the bathtub is not enough, it does not start to work or functions in progress are stopped. Also, the remote control warns about lack of water along with an acoustic signal.

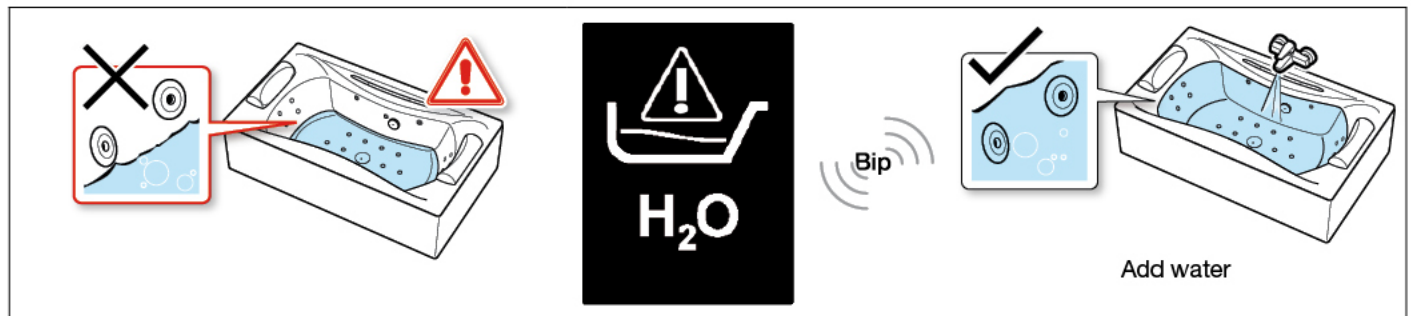

Water Temperature alarm

If the water temperature is 50°C or more, an acoustic signal is activated and the functions in progress are interrupted.

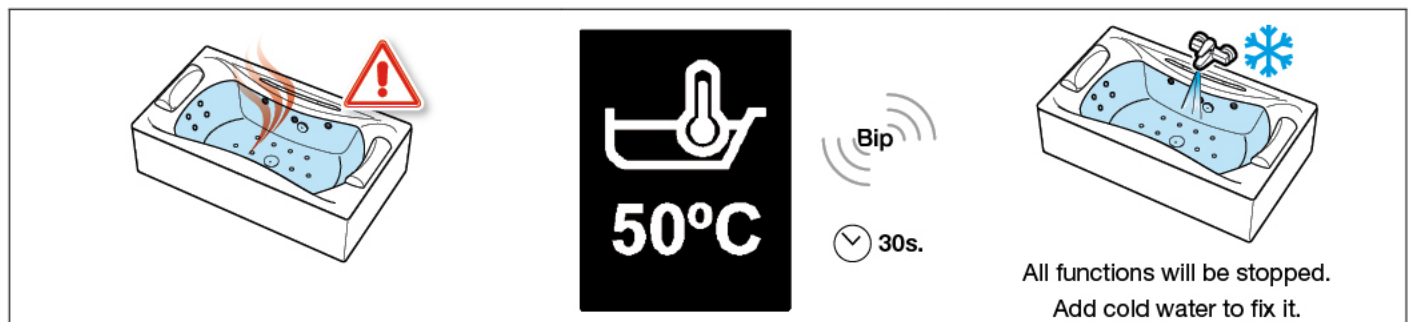

Hydromassage functions



Water massage

The water massage is made by water jets that produce a stimulating effect on our body. In Total Premium bathtubs, water massage consists of a dorsal and plantar massage with jets especially suitable for sensitive areas of the body.



Soft Massage (water+air)

Total massage session: massage that combines the effect of air and water, an integrated experience for an embracing effect perfect to relax your body and your mind. It is a very soft effect and more relaxing than the air massage. This massage is produced through Soft jets that create a Champagne effect.



Air massage

The air massage, is a massage in the form of bubbles that are ejected through small jets at the bottom of the bathtub, obtaining a relaxing massage by the embracing effect of bubbles.



Pulsating air massage

The pulsating air massage increases and decreases its intensity periodically.

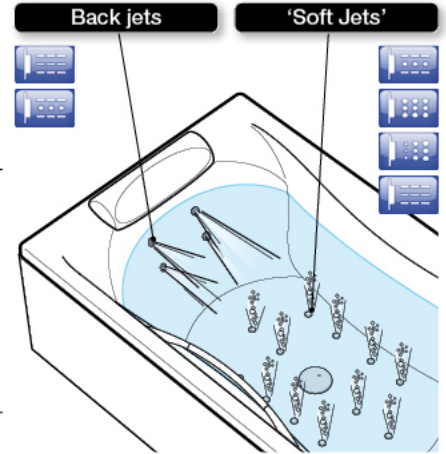

Water massage

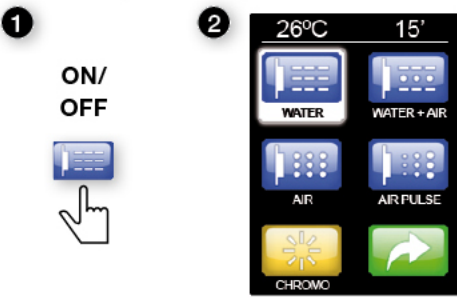

It is not possible to adjust the level of this function.

Soft massage (water+air)

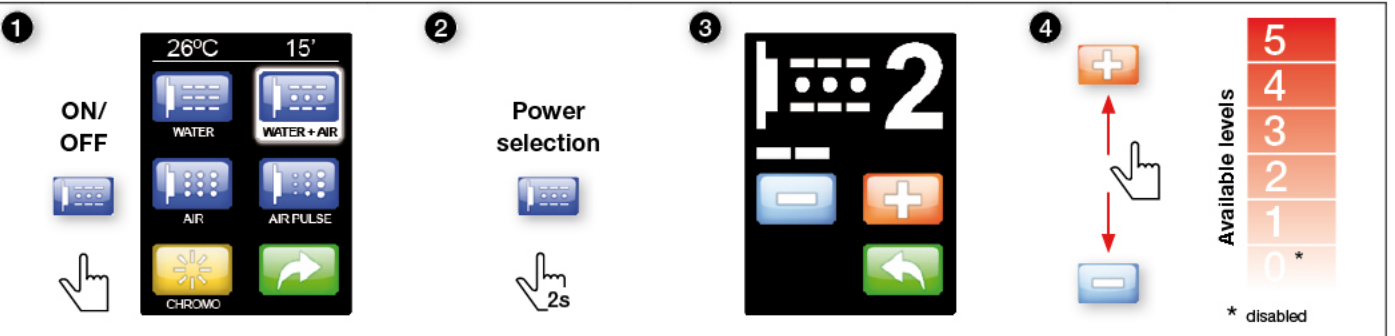

Air massage



- 1 ON/OFF
- 2
- 3 Power selection
- 4
- 4

Pulsating air massage

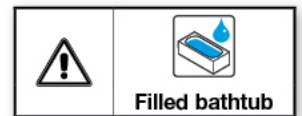

- 1 ON/OFF
- 2
- 3 Selection of the duration of the period
- 4
- 5

Chromotherapy

In Total Premium, you will find the Chromotherapy function. This function is performed through 3 LED lights that change their color to create an embracing effect that perfectly fits in with the hydromassage session.

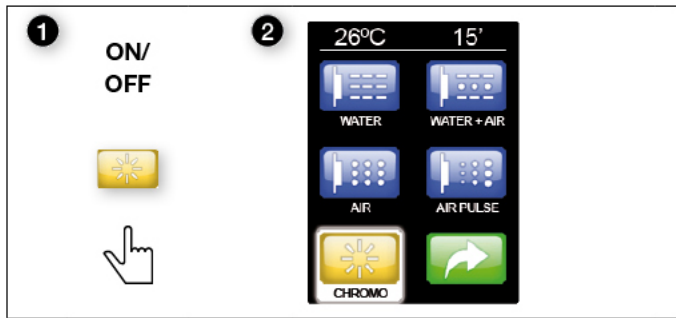
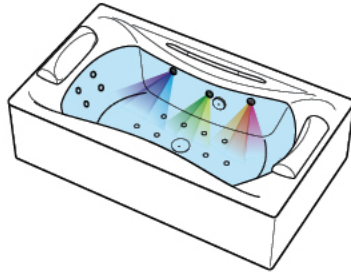

| Colours meaning and use | | |
|-------------------------|---------------------|--|
| 1 | White | Represents purity and the light of day. Feeling of warmth and transparency. |
| 2 | Red | Primary colour warm, stimulating in distress and physical states of weakness in the body. |
| 3 | Blue | Primary colour cold temperament. It has sedative and tranquilizing effect. |
| 4 | Yellow | Synonym of light. It brings optimism, vitality, joy and enthusiasm for life. |
| 5 | Green | It has effects on the mental balance, reassuring. Not for nothing is the colour of nature. |
| | Cycle 'Soft' | Cycle energizing, warm colours and stimulating. |
| | Cycle 'Live' | Sequence of soft colours with a relaxing effect. |

Selection of predefined colors and cycles

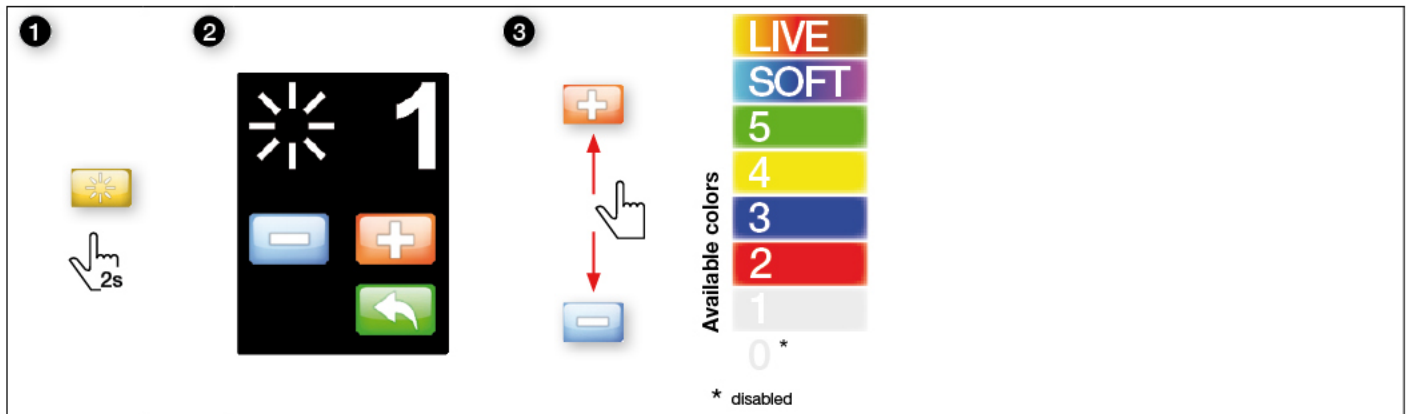

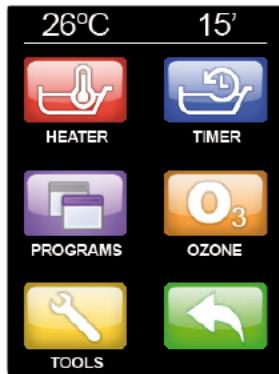

Temperature maintenance

Constant water temperature during the massage.



Timer

Change the duration of the massage between 1 and 30 minutes. The default is 20 minutes.



Programs

The system allows the customization of the massage session, being able to create programs according to the needs and desires of each user by a simple and fast way, or select preset programs.



Ozone disinfection

Ozone in small amounts produces a sanitizing effect throughout the whole hydromassage system, maintaining a clean system every time you use it.



Tools

Options and configuration settings.

Temperature maintenance

1 ON/OFF

2

ON/OFF (single level).
Compatible only with whirlpool Water and Water+Air.
Maintain the temperature of the water that exists at the moment of the activation.

WATER message is OFF

The function will not start if the water massage or soft massage is not activated.

Timer

1 ON/OFF

2

3

4

Bip

Bip

Bip

Time Out

Whirlpool time setting End of hydromassage

Programs

1

2

Program 1 Ultra soft relaxing program that combines a soft hydromassage air with a chromotherapy session with a sequence of basic colors that alternate every 30 seconds.
⌚ 15min.

Program 2 Soft program with a comforting session of bubbles at low level and chromotherapy with color changes every 10 seconds.
⌚ 10min.

Program 3 Relaxing program that includes a varying levels of bubbles massage simultaneously with a chromotherapy session in SOFT mode.
⌚ 10min.

Program 4 Stimulating program that combines a quick sequence of whirlpools of water , air and bubbles massages with chromotherapy session with color changes synchronized with the changes of massage.
⌚ 5min.

Program 5 Tonic program consists of the combination of water massage with pulsating air at maximum level and a session of chromotherapy in LIVE mode.
⌚ 5min.

Filled bathtub

Save new programs

1

(example)

2

3

4 (ejemplo) →

Select the type of massage, power and the desired duration, as well as the color or cycle colors of chromotherapy.

Select any of the numbers available to save the new program.

The new program will replace the previous one.

5

(example)

6

7

The selection of customized hydromassage will be save in the selected program.

Ozone disinfection

| | | |
|--|----------------|--------------------|
| | Filled bathtub | Disabled functions |
|--|----------------|--------------------|

AUTOMATIC MODE

- Select the automatic mode before or during the hydromassage. The setting is saved for future sessions.
- Start** **Auto**
- AUTOMATIC MODE ENABLED**
 End hydromassage
- Active clean system?**
Yes **No**
"YES": the function is activated. The function is also automatically activated after 30 seconds. If you want to cancel automatic disinfection, click "NO".
- Exit the bathtub**
 We strongly recommend leaving the bathroom during the process.
10 seg.
- Clean system active**
12' Remaining time
Total process: 30min.
- End of the process.**
The main screen is displayed (If the remote control is active)

MANUAL MODE

- End hydromassage
- Select the manual mode after the hydromassage.
- Active clean system?**
Yes
- Exit the bathtub**
 We strongly recommend leaving the bathroom during the process.
10 seg.
- Clean system active**
12' Remaining time
Total process: 30min.
- End of the process.**
The main screen is displayed (If the remote control is active)

Tools

| | | |
|---------------------|-------------------------------|--|
| <p>1 </p> <p>2 </p> | <p>Final blowing</p> | <p>This is the procedure of emptying stagnant water from the air circuit after the massage.</p> |
| | <p>Demo mode</p> | <p>It performs a demonstration cycle of the functions of the equipment.</p> |
| | <p>Restore</p> | <p>The default values of all functions and programs are restored.</p> |
| | <p>Synchronization</p> | <p>Synchronize the remote control with the bathtub. It is only necessary to synchronize before the first use.</p> |
| | <p>Status</p> | <p>Help function for technical service. It allows checking the status of the electronic components of the equipment.</p> |

Final blowing

| | | |
|--|----------------------|---------------------------|
| | | |
| | Empty bathtub | Disabled functions |

| | | | | |
|----------------|---|---|---|---|
| AUTOMATIC MODE | 1 | 2 | 3 | <p>The blowing process is activated automatically within finishing the hydromassage and between 30 minutes after; and unless the manual blowing process has been activated before.</p> <p> 15-30s</p> |
| | | | | |
| | | | | |

| | | | | | |
|-------------|---|---|---|---|--|
| MANUAL MODE | 1 | 2 | 3 | 4 | <p>Blowing is started immediately.</p> <p> It will not run if there is water in the bathtub.</p> |
| | | | | | |
| | | | | | |
| | | | | | |

Demo Mode

| | |
|--|-----------------------|
| | |
| | Filled bathtub |

| | | |
|---|---|---|
| 1 | 2 | 3 |
| | | |
| | | |
| | | |

Restore

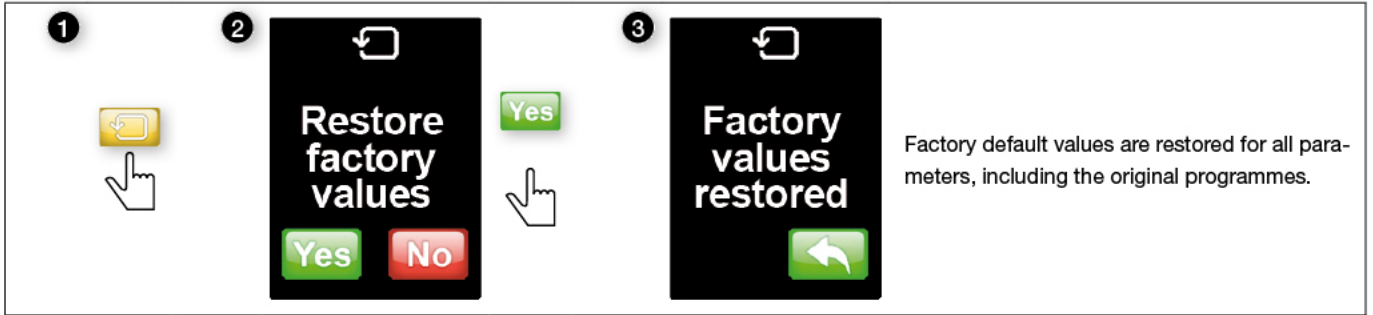

Synchronization

 Synchronization is possible only before the first minute. after connecting the bathtub to the power supply.

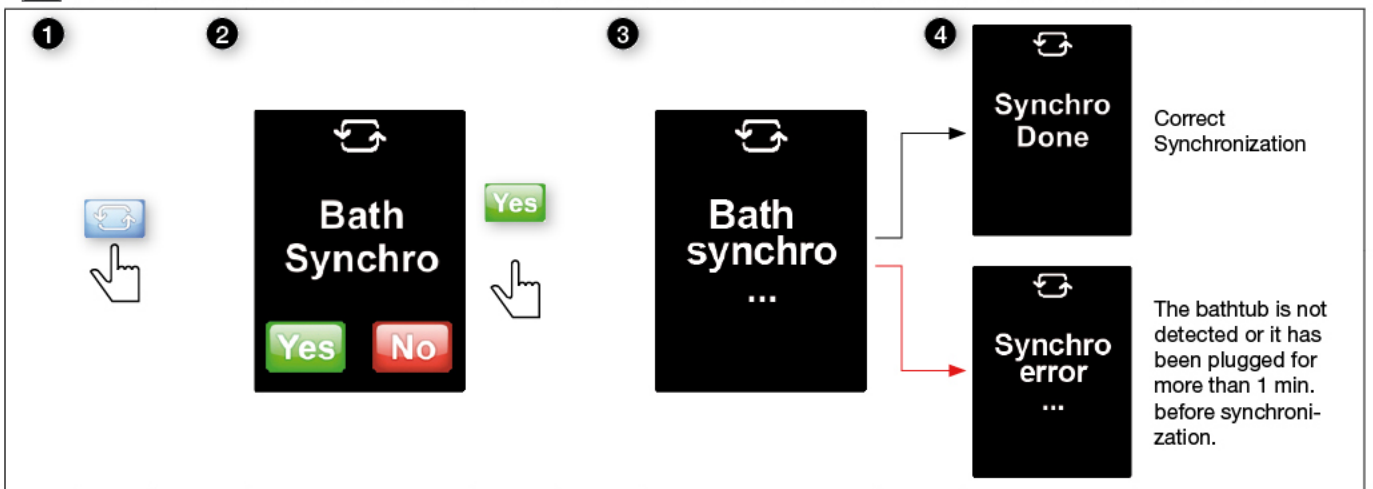

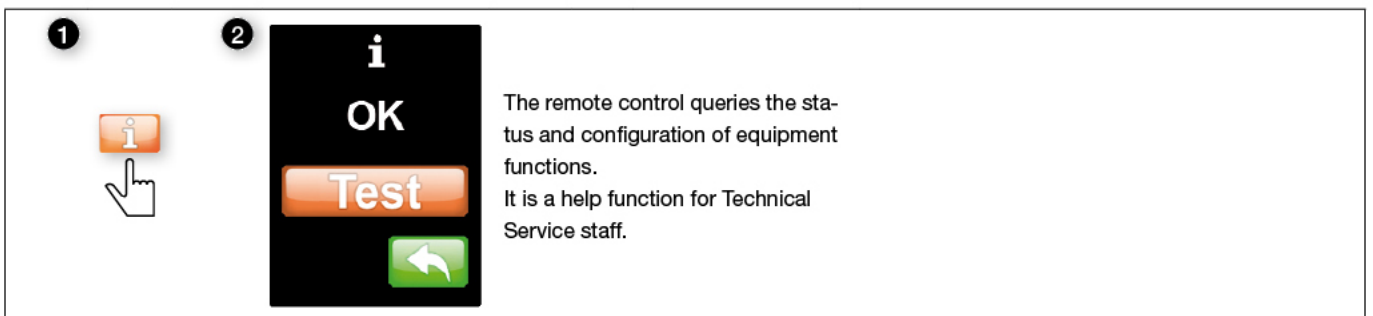

Status



Troubleshooting



| Problem | Possible cause | Solution |
|--|--|---|
| The remote control screen will not turn on | Power supply failure in the remote control. | Change the remote control batteries with new ones |
| Dashes appear in the remote control instead of the numbers of temperature and / or hydromassage time | Power supply failure in the bathtub | Check that there is tension in the power supply |
| | Magnetothermal switch has been tripped | Place it on closed circuit position (ON) If magnetothermal switch trip again, contact Roca Technical Service |
| | No synchronization with the bathtub | Synchronize it with the bathtub (see pg. 13) |
| The hydromassage did not start or the active function unexpectedly stops working | There is not enough water in the bathtub | Fill the bathtub |
| | Water temperature is excessive | Decrease the water temperature |
| | No water arrives to hydromassage system pump | If your bathtub is equipped with a drain with hydromassage suction, the lid must be placed properly, as shown:   |

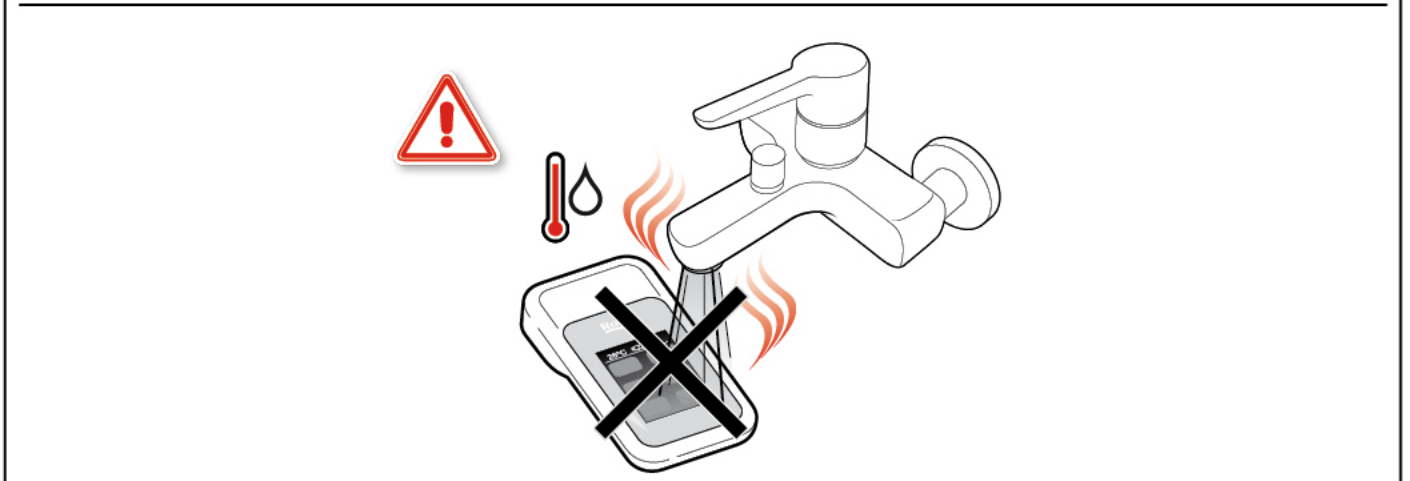
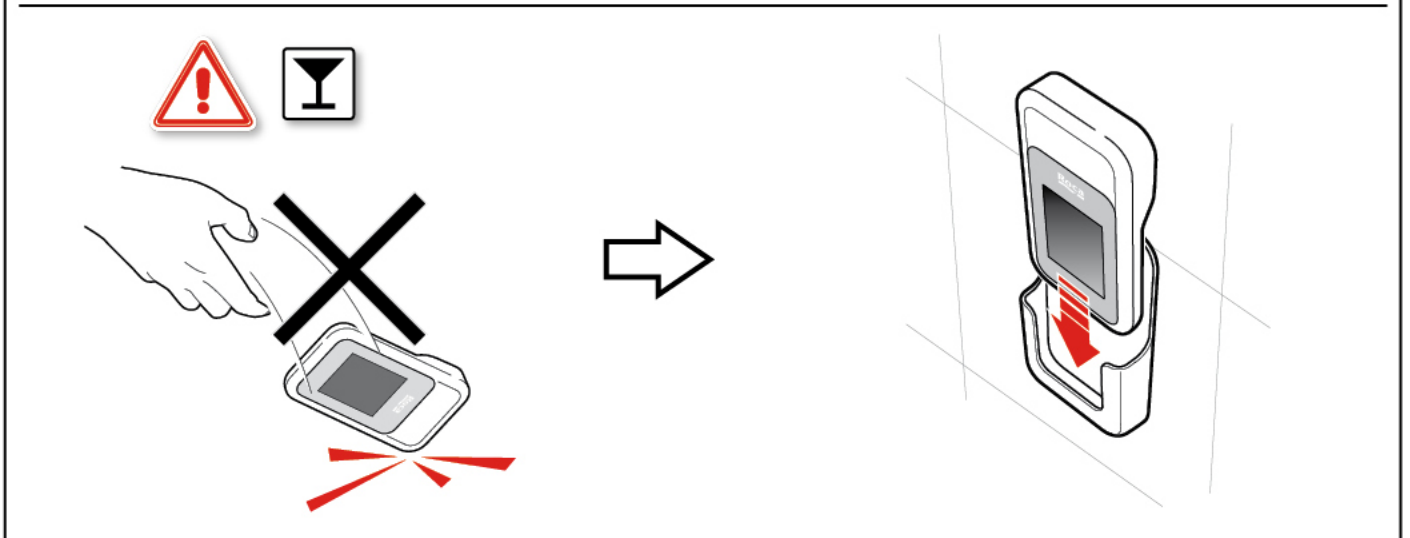
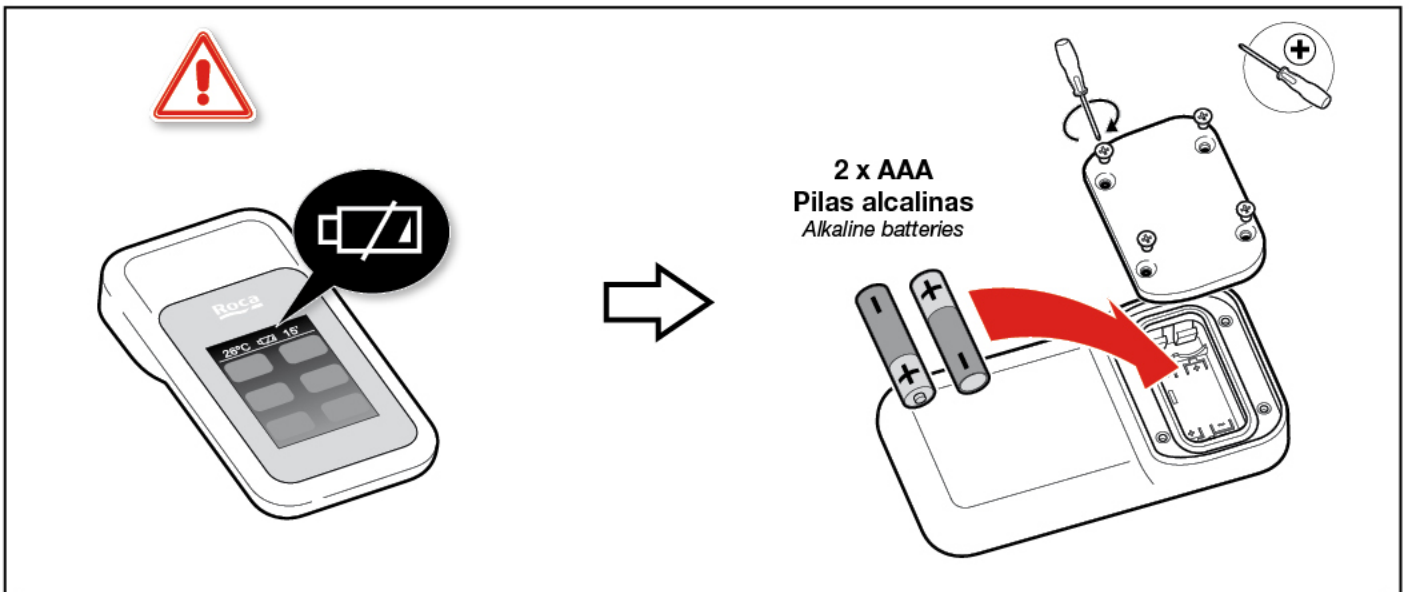
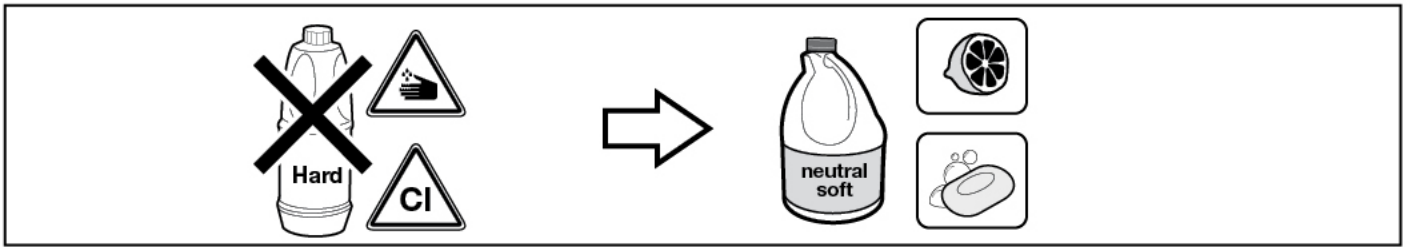



Roca Sanitario, S.A.
Avda. Diagonal, 513
08029 Barcelona
SPAIN
www.roca.com

**902
304
848**  **LÍNEA DE
ATENCIÓN AL
CONSUMIDOR
ESPAÑA**

**902
400
423**  **SERVICIO
TÉCNICO
ESPAÑA**

productsupport.rs@roca.net
soporteproducto.rs@roca.net